



# TS2-400-Z/E

## Fast reference manual

### 【Basic introduction】

#### <1> Type

--Z: equipped with USB-A port; E: equipped with USB-A port, Ethernet port.

#### <2> Software

-- Touch Win Pro software.

### 【Using method】

#### <1> Do not use under the following environment

- Wet and condensation
- Corrosive gas and dust
- Chemical and conducting liquid

#### <2> Layout

- Away from high voltage and current object
- Correct polarity and voltage of the power supply
- Correct connection of the communication cable

#### <3> Cleanness

--The product cover will be corroded by strong acid, alkali, organic solution

### 【Specification】

Input voltage: DC22-26V

Power: 5W

Voltage endurance: AC1000V-10mA 1 minute (signal and ground)

Operation temperature: 0~50°C

Storage temperature: -10~60°C

Ambient humidity: 10~90% (no condensation)

Protection level: the front panel complies with IP65

### 【Function】

Resolution: 480×272 pixels

Screen size: 4.3 inch

Display: TFT true color, 16 million colors

CPU: Cortex-A7 1GHz

Memory: 64MB

Picture editing: upper computer editing, easy to learn, vivid picture, supporting bmp and jpeg format

Button: touch mode

Communication: can communicate with most PLCs in the market, such as Siemens, Mitsubishi, supporting frequency inverter and meters.

COM port: USB-A, USB-B, COM1(RS232), COM2(RS485), RJ45.

Special function: data backup (CSV file export and import), self-defined flash, X/Y trend map.

### 【Installation】

#### <1> Dimension (unit: mm)

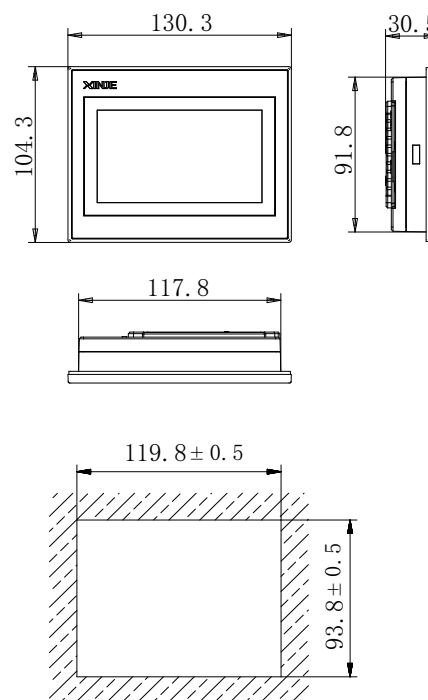

This mounting dimension is for your reference only.

#### <2> Fix the product

- insert the product into mounting hole;
- insert the frame into the mounting hole then tighten the screw.

**Note:** --the tighten strength should be moderate.

--the screw should be vertical with the mounting panel.

## 【Part description】

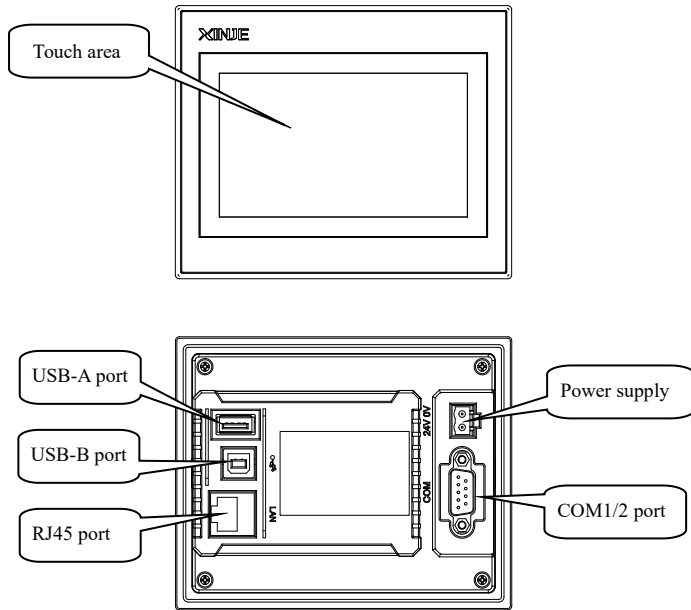

**Notes:** --USB-A port is used to connect flash disk, export and import “csv” data.

--USB-B port is used to download program.

--RJ45 port is used to Ethernet communication.

## 【COM port】

No.	Name	No.	Name
1	NC	6	NC
2	COM1 RXD	7	COM2 B
3	COM1 TXD	8	NC
4	COM2 A	9	NC
5	COM1 GND		

COM1/2 pin definition

## 【Download the program】

Download program via USB-B port and USB cable.

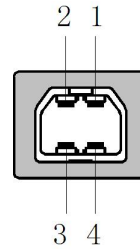

Pin	Name	Description
1	+5V	+5V voltage signal
2	DATA-	Data - signal
3	DATA+	Data + signal
4	GND	Signal ground

## 【Communication function】

--COM1 and COM2 have communication functions; can connect to various devices, such as PLC, inverters.

## 【Making a project】

Making a project includes the following steps:

### <1> Build a new project

Open the software, click “”, select the HMI type and PLC type.

### <2> Edit the project

Please refer to TS series HMI user manual.

### <3> Download the project

Connect the download cable correctly, click “” to finish download.

### <4> PLC communication

Connect the cable to the PLC, then it can exchange data with PLC.

**Note:** --For detailed information, please refer to the user manual.

--You can use Xinje cable or make the cable according to the cable diagram.